

Patient Aids

- Skin Care 618-625
- Left Foot Gas Pedal 626
- Shoe Horns 626
- Xerosox Prosthetic Protectors 626
- Disposable Shorts 627
- Donning Devices 627-628
- Helmets 628-629
- Padded Head Halter 629
- Canes, Crutches and Accessories 629-634
- Walkers and Accessories 634-639
- Commodes 640

Patient Aids

ALPS - Silicone Skin Lotion

- 100% silicone skin lotion helps to smooth dry, sensitive skin
- Hypoallergenic, with no perfumes or dyes
- Leaves no oily feeling and can be used sparingly to achieve relief for dry, chapped skin conditions

Description	Product No.
4 oz Bottle	SL108
32 oz Bottle	SL108/32



SL108

Cleanser -16 oz bottle (not pictured)

- Non-alkaline, soap-free cleanser which can be used for either hand or machine washing of prosthetic liners and sleeves
- Patients with sensitive skin may also find that this soothing cleansing agent is ideal for washing skin areas that come into contact with the prosthesis

Product No. **PD595**



PA604

Lubricant (16 oz bottle)

- Designed for donning silicone prosthetic liners
- Eliminates the sticky feel and allows the patient to roll up the liner or sheath easily
- 70% Isopropyl Alcohol

Product No. **PA604**



PO840

Ointment (4 oz tube)

- Vitamin A and D formulation that soothes, protects and helps to promote healing and reduce the pain of skin rash or superficial skin injuries
- May deteriorate gel overtime

Product No. **PO840**



ATP008

Antiperspirant

- Designed for prosthetic patients to help manage the continuing problem of perspiration
- 4 oz spray

Product No. **ATP008**

Fitting Lotion

- 4 oz bottle

Product No. **FL801**



FL801

Amerx - AmeriGel® Wound Dressing (1 oz tube)

- Antimicrobial, anti-inflammatory, antifungal hydrogel
- Includes naturally derived Oakin® for debriding action, as well as zinc acetate and polyethylene glycol (PEG)
- Kills 99.2% of MRSA in 24 hours
- Provides a moist wound environment
- Ease of application and use increases patient compliance
- 1 oz tubes, 24 tubes per case

Indications: Stage I-IV pressure ulcers, venous stasis ulcers, diabetic skin ulcers, 1st and 2nd degree burns, post-surgical incisions with dehiscence, cuts and abrasions



Product No. **A2001**

AmeriGel Care Lotion (8 oz)

- A dimethicone-based moisturizer, exfoliant and keratolytic agent
- Formulated to manage eczema, psoriasis, xerosis, ichthyosis, bromhidrosis, heel fissures, minor burns and rashes
- Antimicrobial, antifungal and antipruritic
- Deep moisture treatment works beneath the skin to reduce inflammation and irritation and to restore healthy skin
- 3-in-1 product for head to toe treatment
- 8 oz tubes, 24 tubes per case

Product No. **A2068**



AmeriGel Saturated Gauze Dressing

- Sterile, non-woven 4-ply gauze, impregnated with AmeriGel Wound Dressing hydrogel
- Helps to combat infection and reduce wound bioburden
- Stays moist for up to 7 days
- Safe for use over Bioengineered Alternative Tissue (BAT)
- Size: 2" x 2"
- Case of 12 boxes, 10 pads per box

Indications: Stage I-IV pressure ulcers, venous stasis ulcers, diabetic skin ulcers, 1st and 2nd degree burns, post-surgical incisions with dehiscence, cuts and abrasions

Product No. **A5002/12**



AmeriGel Post-Op Surgical Kit

- Packaged for continuous 30-day post-operative care
- Provides patients with cost-effective convenience while giving the healthcare professional control of consistent, compliant results
- Each kit contains:
 - AmeriGel Wound Dressing (1 oz tube)
 - AmeriGel Wound Wash (4 oz)
 - 30 each 1" x 3" latex-free fabric bandages
 - 30 each 4-ply non-woven 2" x 2" gauze pads
- Provides an antimicrobial barrier at wound site
- Reduces healing time by 20-50%

Product No. **A2002**



Patient Aids

Performance Health - BioFreeze Topical Pain Reliever (Gel Pump or Tube)

- Used by practitioners and patients to massage muscles and joints for pain reduction and increased range-of-motion
- Applicable for sprains, strains, arthritis, bursitis, tendinitis or neuromas

Size	Product No.
4 oz tube	BUSAT04-144
16 oz Gel Pump	BUSAP16-024
32 oz Gel Pump	BUSAP32-016
1 gal Gel Pump	BUSAPGA-004



BioFreeze Topical Pain Reliever (Spray)

- Useful to reduce pain and muscle spasms before and after activities for acute conditions such as sprains and strains
- Great for wide areas of application

Size	Product No.
4 oz	BUSAS04-144
16 oz	BUSAS16-018





BioFreeze Topical Pain Reliever (Roll-on)

- Sanitary roller can be applied to stimulate trigger points in the office or with instruction to the patient for self massage at home
- Easy application to painful areas during daily activities
- 3 ounces

Product No. **BUSAR03-144**

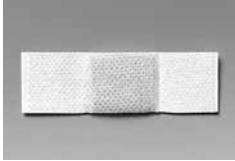
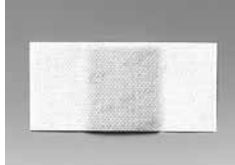

Ferris Manufacturing - PolyMem® QuadraFoam®

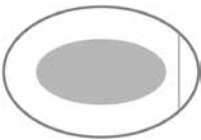
Description	Dimensions	Quantity	Product No.	
Adhesive Film Dressing	2" x 2" Dot	20 per box 5 boxes/case	203FER	
Adhesive Cloth-Backed Dressing	1" x 3" Strip	20 per box 5 boxes/case	7031FER	
Adhesive Cloth-Backed Dressing	2" x 4" Strip	20 per box 5 boxes/case	7042FER	
Adhesive Cloth-Backed Dressing	2" x 2" Dot	20 per box 5 boxes/case	7203FER	
Silver Dressing #3	2" x 3" Oval	20 per box 5 boxes/case	1823FER	

Patient Aids

Ossur Americas - Iceross® Clean & Simple Set

- Includes one bottle of soap, moisturizing lotion and lubricant spray

Product No. **S-010001**



S-010001

Iceross Clean & Simple Moisturizing Lotion

- A non-greasy restorative lotion that nourishes and softens the skin
- Free from fragrances and dyes
- It has a pH of 5.5 and is hypo allergenic
- 250 ml/8.8 oz

Product No. **S-410250**



S-410250



S-610250



S-210250

Iceross Clean & Simple Lubricant Spray

- Aids the donning and doffing of Iceross Seal-In X5 Liners and Iceross Original Liner without fabric cover
- 250 ml/8.8 oz

Product No. **S-610250**

Iceross Clean & Simple Soap

- Iceross Clean & Simple soap is a mild liquid soap for daily hygienic treatment of the skin and the silicone liner
- Free from fragrances and dyes, it is designed for sensitive skin and contains natural ingredients that nourish and soften the skin
- It has a pH of 5.5 and is hypo allergenic (250 ml/8.8 oz)

Product No. **S-210250**

SPS - Liquid Silk Body Powder

- Also known as Dry-Lite™
- 18 oz bottle

Product No. **LS100**



LS100

Trulife - Liquid Body Powder

- Effective, safe, non-allergenic
- Controls chaffing, perspiration and odor while soothing areas of friction
- 8 oz bottle

Product No. **57751**



57751

Fillauer - Cornstarch Baby Powder

- Corn Starch, 15 oz

Product No. **199386**



199386

Talc Baby Powder

- 14 oz

Product No. **51393**



51393

B.F.I. First Aid Powder

- First aid to help reduce the risk of skin infection in minor cuts, scrapes and burns
- Antiseptic dusting powder; soothing, protective, absorbent
- Active Ingredients: Bismuth-Formic-Iodide, 16%
- 1.25 oz

Product No. **86214**



86214

Cold Spray

- Relieves hot conditions
- Lowers surface temperature
- 6 oz can

Product No. **C7454**



C7454

It Stays Adhesive

- Gentle roll-on body adhesive that washes off with water
- 2 oz bottles; 12 bottles per case

Product No. **6**



SPS - Odor Eliminator

- All natural product that kills odor causing bacteria safely and without chemicals
- The regeneration of bacteria can take weeks, which is why Odor Eliminator lasts, even after showering; after using Odor Eliminator for a few months, the patient will find the need for re-application less frequent
- 1/2 oz (15 g) jar

Product No. **OE100**



Diabetic Basics - Antimicrobial Instant Foot Sanitizer

- Colorless, water-based spray product sanitizes, moisturizes with skin softeners and emollients and helps prevent infection, killing 99.9% of germs
- An option for amputee use
- 8 oz spray bottle

Product No. **BAS-29001**



Moleskin

Description	Color	Product No.
12" x 5 yards	White	58369
12" x 5 yards	Flesh	58364
* contains latex		

AmpuBalm

- 3³/₄ oz jar, 24 jars per case
- Protects abrasions from further chafing or injury

Product No. **582001**



Adaptskin

- Protection for amputees who experience skin breakdown, heat rash, abrasions, chafing, dry skin and other residual limb irritations
- Hypoallergenic, penetrates to form a waterproof barrier
- Compatible with mineral oil, silicone and urethane liners
- Adaptskin 50™ is Medium viscosity for more general applications and daily use
- Adaptskin 90™ is a thicker, more concentrated product for high abrasion areas or severe skin damage

Description	Product No.
Adaptskin 50	AS5004J
Adaptskin 90	AS9004J



2nd Skin™ Dressing

- Increases healing speed
- Prevents wounds from drying out
- Reduces risk of scarring
- Latex free

Description	Product No.
3" circles, 48 per jar, non-sterile	10-603
2 pads, 3" x 6 ¹ / ₂ ", non-sterile	47-209
4 pads, 2" x 3", sterile moist burn pads	47-019



DonJoy (DJO) - IceMan® Cooler

- Provides up to seven hours of continuous therapy unit provides up to seven hours of continuous cold thereapy for a variety of indications
- Patented circulation system allows the IceMen to provide constant and accurate temperature throughout the pad, preventing freezing inlet temperature from occurring
- Can greatly reduce the need for post-operative pain medications, reducing swelling and facilitate rehabilitation



Product No. **11-0494**

IceMan® Cold Shoulder Wrap (not pictured)

- Packs provide 2 hours of cold with one application
- Removable inserts can be exchanged for extended cryotherapy
- The ice packs are malleable to provide comfortable cold therapy
- Ultra-wick fabric with antimicrobial protection
- Universal sizing, 12" x 13"

Size	Product No.
Small/Medium	11-0611-9-00000
Large/X-Large	11-0612-9-00000

IceMan® Sterile Cold Pads

- Designed with hook engageable material and stretch band to easily wrap around affected area
- Universal sizing

Size	Product No.
Universal 10.85" x 11.34"	11-0801-9-00000
Universal X-Large 12" x 11.34"	11-0804-9-00000

IceMan® Wrap-On Pads

- Non-sterile pads are designed with hook engageable material and stretch band to easily wrap around affected area
- Universal sizing

Description	Measurements	Product No.
Universal Shoulder Wrap-On	—	11-1334-9-00000
Universal Shoulder Wrap-On, RH	—	11-1397-9-00000
Knee Wrap-On	10.85" x 11.34"	11-1268-9-00000
Universal, RH	10.85" x 11.34"	11-0679-9-00000
Universal, EH	12" x 11.34"	11-0680-9-00000
Universal, XL, RH	12" x 11.34"	11-0681-9-00000
Universal, XL, EH	12" x 11.34"	11-0682-9-00000

Wrap-On = Loop | RH = Regular Hose 6.5" | EH = Extended Hose 15"



Patient Aids

Drive-Master Co. - Left Foot Gas Pedal

- Designed for people with limited or no use of their right foot
- Quick release gas pedal can be installed in any vehicle with an automatic transmission
- No adjustments necessary after installation
- Pedal stop will not allow right foot to inadvertently apply throttle

Product No. **D7M**



AliMed - Stainless Steel Shoe Horn (not pictured)

- No-slip vinyl handle with a 180° hooked end to assist grasp
- Can also be used to drag shoes into position
- Length: 18"

Product No. **8185**

Justin Blair & Co. - Pro Metal Shoe Horn

- Dozen per box

Product No. **583120**



AliMed - Xerosox Prosthetic Protectors

- Designed as a cast/bandage/prosthetic protector to create a watertight vacuum seal
- Eliminates air from the cast or bandage by simply squeezing the built-in hand pump
- Removal is easy: Gently lift the cuff to let the air back in
- Non-skid grid provides secure footing

Description	Circumference	Length	Product No.
Xerosox Prosthetic Leg Protector			
Small	11"-15 ¹ / ₂ "	32"	PL-14
Medium	15"-17"	35"	PL-16
Large	16 ¹ / ₂ " and up	37"	PL-18
Xerosox Pump Leg Protector			
Small Half Leg	10"-13"	21"	HL-13
Large Half Leg	13" and up	23 ¹ / ₂ "	HL-15
X-Small Full Leg	7 ¹ / ₂ "-11"	19"	FL-12
Small Full Leg	14"-16 ¹ / ₂ "	29"	FL-14
Medium Full Leg	16 ¹ / ₂ "-21"	33"	FL-16
Large Full Leg	21" & up	37"	FL-18
Xerosox Pump Arm Protector			
Small Half Arm	7 ¹ / ₂ "-9 ¹ / ₂ "	16 ¹ / ₂ "	HA-13
Large Half Arm	9 ¹ / ₂ " and up	18 ¹ / ₂ "	HA-15
X-Small Full Arm	6"-7"	15"	FA-12
Small Full Arm	7"-9"	21"	FA-14
Medium Full Arm	9"-10"	26"	FA-16
Large Full Arm	10" & up	28 ¹ / ₂ "	FA-18



Medline - Disposable Exam Shorts

- Available in multi-layer material for comfort and fluid resistance
- Elastic waist provides a snug fit
- Available in Blue
- Latex free
- 30 per case

Product No. (1 case)

NON27209L



Tidi - Disposable Boxer Shorts

- 25 per bag

Size	Product No.
Medium	960400
Large	960401
X-Large	960402
2X-Large	960404



Patient Aids

Arion North America - Easy-Slide Donning Sleeve

- Ultimate donning aid for open toe compression stockings
- Reduces physical strain for both caregiver and user
- Increase in patient's independence and therapy compliance
- Stockings retain therapeutic graduated compression longer
- Easy to use; durable

Size	Color	Shoe Size		Product No.
		Womens	Mens	
X-Small	Green/Orange	up to 3	up to 2	E01500
Small	Green/Orange	3-6	2-4 ¹ / ₂	E01501
Medium	Green/Orange	6 ¹ / ₂ -9 ¹ / ₂	5-8	E01502
Large	Green/Orange	10- 13	8 ¹ / ₂ -11 ¹ / ₂	E01503
X-Large	Green/Orange	13 ¹ / ₂ +	12+	E01504



Easy-Slide Caran

- Same material as Easy-Slide, but designed for use with closed toe compression stockings
- Hook and loop release

Size	Color	Circ. of Widest Part of Foot	Product No.
Small	Green/Orange	up to 8"	E01507
Medium	Green/Orange	8"-10"	E01508
Large	Green/Orange	10"+	E01509
Easy-Slide Arm Donning Sleeve			
Medium	—	—	E01505
Large	—	—	E01506
Easy-Off Stocking Removal Aid			
Small	—	—	E01804
Medium	—	—	E01904
Large	—	—	E02002

Danmar Products - Soft Shell Helmet

- Fully ventilated without compromising head coverage
- Constructed from 1/2" thick shock-absorbing foam and vinyl coated with Fabriccoat
- Easy to clean; just hand wash with warm soapy water
- Average Weight: 8 oz
- Available in Tan, Royal Blue, Pink; specify color when ordering

Size	Circumference Range	Product No.
2X-Small	17 ¹ / ₂ "-18 ¹ / ₄ "	9820XXS
X-Small	19"-19 ³ / ₄ "	9820XS
Small	20 ³ / ₄ "-21 ¹ / ₂ "	9820S
Medium	21 ¹ / ₂ "-22 ¹ / ₄ "	9820M
Large	23"-23 ³ / ₄ "	9820L
X-Large	24"-24 ³ / ₄ "	9820XL
2X-Large	25 ¹ / ₂ "-26 ¹ / ₄ "	9820XXL



Hard Shell Helmet

- Fully ventilated without compromising head coverage
- Strong polyethylene shell covers a shock absorbent foam liner
- Easy to clean; just hand wash with warm soapy water
- Average Weight: 17 oz
- Available in Tan, Royal Blue, Pink; specify color when ordering

Size	Circumference Range	Product No.
2X-Small	17 ¹ / ₄ "-18"	9821XXS
X-Small	19 ¹ / ₄ "-20"	9821XS
Small	20 ¹ / ₂ "-21 ¹ / ₄ "	9821S
Medium	21 ¹ / ₂ "-22 ¹ / ₄ "	9821M
Large	22 ¹ / ₂ "-23 ¹ / ₄ "	9821L
X-Large	24 ¹ / ₂ "-25 ¹ / ₄ "	9821XL
2X-Large	26"-26 ³ / ₄ "	9821XXL



Full Coverage Helmet

- Lightweight foam helmet designed to cover the temporal/cheek area as well as additional coverage around the ears and neck
- Easily adjustable chin strap with snap closure
- Applicable in situations where coverage of both head and cheek is advised
- Available in Tan, Royal Blue, Pink; specify color when ordering

Size	Circumference Range	Product No.
2X-Small	17 ¹ / ₄ "-18"	9829XXS
X-Small	19 ¹ / ₄ "-20"	9829XS
Small	20 ¹ / ₂ "-21 ¹ / ₄ "	9829S
Medium	21 ¹ / ₂ "-22 ¹ / ₄ "	9829M
Large	22 ¹ / ₂ "-23 ¹ / ₄ "	9829L
X-Large	24 ¹ / ₂ "-25 ¹ / ₄ "	9829XL
2X-Large	26"-26 ³ / ₄ "	9829XXL



ProCare (DJO) - Padded Head Halter

- Adjustable loop holder and flannel lined for patient comfort
- Can be applied for hyperextension or flexion
- Comes 12 per pack

Indications: Cervical strains; Degenerative disc disease

Product No. **79-83040**



Patient Aids

PCP/Champion - Offset Handle Models

- Adjustable 31"-39"
- Gray vinyl grip, silver shaft

Product No. **5085**

Curved Handle Models

- Adjustable 31"-39"
- Gray vinyl grip, silver shaft

Product No. **5086**



Unipoise Single Point Cane

- 7/8" Offset Handle; Adjustable from 31"-40"
- 300 lb weight limit

Product No. **G05355**



G05355

Adult Small Base Quad Cane

- Anodized 7/8" silver aluminum shaft
- Low profile steel base, chrome finish, narrow or wide
- Offset handle, contoured vinyl handgrip
- Spring button height adjustment
- Reinforced rubber tips
- Base Dimensions: 6" x 8"
- Height Adjustment: 29"-38"

Product No. **G05345S**



G05345S

Low Profile Quad Cane (not pictured)

- 7/8" aluminum shaft
- Low profile steel base
- Offset handle, molded gray vinyl handgrip
- Safety lock silencer ring

Description	Product No.
Narrow Base, 6" x 8"	5095
Wide Base, 8" x 12"	5096

Medline - Offset Handle Aluminum Cane

- Contoured handle with foam handgrip comes with a wrist strap to provide comfort and a secure grip
- Handle height adjusts in one-inch increment from 29"-38" and is secured with a locking ring for added safety
- Offset handle aluminum cane with wrist strap
- Available in Black
- 250 lb weight limit

Product No. **MDS86420**



MDS86420

Offset Handle Cane - Bariatric

- All-steel construction
- Solid brass, double push button adjustment for extra stability
- Handle height adjusts in one-inch increment from 29"-38" and is secured with a locking ring for added safety
- PVC handgrip
- Double-tubing insert for added strength and safety
- Available in Black
- 500 lb weight limit

Product No. **MDS86420XW**



MDS86420XW

Large Base Quad Cane

- Double-plated base with extremely strong welds
- Solid brass, push button adjustment for extra stability
- Handle height adjusts in one-inch increment from 29"-38" and is secured with a locking ring for added safety
- All-steel construction
- Black shaft
- 500 lb weight limit
- 8"x12" black footprint

Product No. **MDS86228XW**



MDS86228XW

Aluminum Large Base Quad Cane

- Dual push-button adjustment mechanism with locking ring allows for quick, secure fitting and to be ambidextrous
- Height adjusts from 30" to 39"
- The non-skid rubber tips with metal inserts ensure a secure grip and long lasting performance
- No assembly required
- Aluminum construction
- 250 lb weight limit
- Available in Black

Product No. **MDS86228**



MDS86228

Aluminum Small Base Quad Cane

- Dual push-button adjustment mechanism with locking ring allows for quick, secure fitting and to be ambidextrous
- Height adjusts from 30" to 39"
- The non-skid rubber tips with metal inserts ensure a secure grip and long lasting performance
- Aluminum construction
- No assembly required
- 250 lb weight limit
- Available in Black

Product No. **MDS86222W**

Medline - Aluminum Forearm Crutches, Adult

- Built tough for long-lasting performance
- Recommended for long-term disability
- Contoured vinyl handgrips provide comfort and long wear
- 250 lb weight limit

Description	Height	Product No.
Tall	5'10" to 6'6"	MDS805160
Average	5'0" to 6'2"	MDS805161



MDS805161

Forearm Crutches

- 1" anodized aluminum tubing
- Vinyl coated cuffs with 180° pivot and nylon pivot block
- Gray handgrips on welded and coated steel handles
- Spring button adjustments at both legs and forearm cuffs
- Metal reinforced rubber tips

Description	Height	Product No.
Adult	5'2"-6'2"	5090
Junior	4'2"-5'2"	5090-J



5090

Quick-Fit Crutches

- Bolt-adjusted handle and push-button adjusted foot pieces with fitting scale allow for accurate fitting
- Aluminum; Latex-free rubber components
- 300 lb weight limit

Description	Height	Product No.
Tall	5'10" to 6'6"	G50314-8
Adult	5'2" to 5'10"	G51314-8
Youth	4'6" to 5'2"	G52314-8
Child	3'9" to 4'7"	G53314-8



G51314-8

Red Dot Aluminum Crutches

- Clip-lock adjusted handle and push button adjusted height allows for 10 second adjustments
- 1" adjustment increments on both handle and height provide a precise fit which reduces muscle fatigue
- Latex-free rubber components
- Fits patient height 5'1" - 5'9"
- 300 lb weight limit

Product No. **G91-214-8H**



G91-214-8H

Heavy Duty Tall Adult Crutches

- Oversized wing nut and push-button for quick height adjustment
- Metal ring helps prevent excessive wear and ensures maximum durability
- Aluminum
- Latex-free rubber components
- 650 lb weight limit

Description	Product No.
Tall Adult	MDS80334XW
Adult	MDS80335XW



Bariatric Crutches

- Heavy-duty steel construction provides durability
- Push-button adjusted foot pieces with fitting scale allow for accurate, fast fitting
- 1" adjustment increments on both handle and height provide a precise fit which reduces muscle fatigue
- Supports up to 550 lbs

Description	Height	Product No.
Adult	5'1"-5'9"	G61314B
Adult Tall	5'10"-6'6"	G60314B



Wood Adjustable Crutches

- Made from strong weather resistant laminated hardwood
- Preshaped bows allow for quick and easy adjustment
- Includes tip, grip and underarm cushions

Description	Height	Product No.
Adult	5'4"-6'5"	5073-S
Medium	4'1"-5'7"	5074-S
Junior	4'5"-5'	5075-S
Child	3'8"-4'4"	5076-S



Super Crutch Tips

- Cushion base absorbs shock and provides extra comfort
- For sure footed traction the extra wide vacuum seal rings grip when weight is applied and release when weight is removed
- Fits: 7/8" (2.2 cm) shafts
- Base Diameter: 2 1/16" (5.2 cm); Overall Height: 3 1/16" (7.8 cm)
- Available in Gray
- Sold by the pair

Product No. **G00842**



Standard Crutch Tips

- 100% natural rubber
- Metal disc molded into tip prevents foot piece cut through
- Fits: 7/8" (1.9 cm) shafts
- Base Diameter: 1 3/4" (4.4 cm); Overall Height: 2 1/2" (6.3 cm)
- Available in Gray
- Sold by the pair

Product No. **G00502**

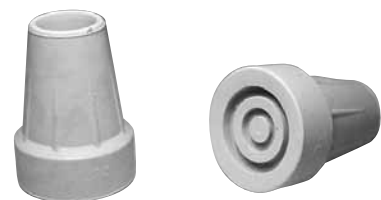

Crutch Handgrips

- Provides sturdy support that alleviate blistered hands, cramped fingers, wrist tension and pressure on sensitive nerves
- For crutches with removable handles
- Neoprene added for strength
- Available in Tan



Description	Product No.
Open Style	5071
Closed Style	5072

Crutch Pads

- High density reinforced rubber with molded-in fabric keeps the cushion from splitting or tearing
- Extra thick at the top for maximum comfort
- Natural rubber compound with corrugated cell construction provides a snug, tensioned fit to the arm piece
- Ribbed design adds additional comfort
- Fits all adult and medium crutches
- Available in Tan



Product No. **5070**

Crutch Tips

- Shock absorbing concave base

Size	Color	Product No.
Small	Tan	6099-T
Medium	Tan	6100-T
Large	Tan	6101-T



AliMed - Aluminum Four-Wheel Rollator

- Lightweight and versatile (13 lbs)
- Easily folds for quick storage
- Large nylon pouch under seat to store necessary items in transit
- Locking loop brakes
- 300 lb weight limit
- Adjustable handle height (33"-38")
- Dimensions: 23" W x 23" L
- Seat: 13" D x 14" W x 22" H

Product No. **77016**



One-Button Foldaway Walker

- Polished aluminum frame
- Pinch-proof release button
- Folds for easy storage and transportation
- High cross brace design allows walker use over commodes
- Cushioned handgrips
- 350 lb weight limit
- Height adjusts in 1" increments
- Dimensions: 31" - 38" H x 18" D (3¹/₂" folded)

Product No. **74261**



Medline - Rollator Deluxe Walker

- Rolling walker has a padded seat, curved back seat and loop brakes for quick and easy stopping
- Easy to maneuver and folds for storage
- Basket comes standard
- Available in Burgundy
- Hand grips adjust to patient height (32"-36" from floor)
- Seat dimensions are 14" x 14"; 22" height from floor
- Weight: 16 lbs
- 250 lb weight limit
- Base Dimensions (when fully extended): 24" W x 22" L

Product No. **MDS86810**

Strider™ Prescription Walker

- Handles adjust to an infinite number of positions to provide stability and posture
- Extra wide base provides stability, safety and balance
- Large 5" wheel foot pieces will easily roll over irregular surfaces
- Options include platform attachment, plus horizontal or vertical handles which may be used in any combination or position
- All adjustments accomplished without tools
- Can be used as a trailing walker or in the traditional forward position

Regular

- Approximate Patient Height: 4'8"-6'4"
- Available in Black
- Weight: 9 lbs
- Height Adjustment: 28"-40"
- Base Width: 27"

Product No. **G07780**



Children’s Folding Walker (not pictured)

- Height-adjustable “grow with you” design
- Adjustable from 20.5”-24.5”

Product No. **G07750**

Extra Wide Folding Walker

- Two button folding allows independent operation of each side so walker fits through narrow spaces
- Easy to use folding mechanism is designed for operation with palm, finger or arm
- Lightweight, polished 1” aluminum tubing with dual steel cross bars supports up to 400 lbs
- Contoured vinyl handgrips

Description	User Height	Product No.
Adult	5’5” to 6’4”	G07767
Youth	5’-6’	G07768



Easy Care Folding Walker

- Dual folding mechanism is easy to operate with palms or fingers
- Ideal for those with limited dexterity
- Lightweight aluminum frame with steel cross brace provides durability
- Supports up to 300 lbs

Description	Max User Height	Product No.
Adult	6’2”	G30755P
Youth	5’6”	G30756P



Two Button Folding Adult Walker

- Height adjustable 32¹/₂” to 39¹/₂”
- Each side operated independently to provide easy movement through narrow spaces and greater stability when standing up
- Contoured textured latex free PVC handgrips provide additional comfort
- 5” wheels
- Width inside handgrips: 18”; width inside base legs: 21”; depth opened at base: 16”
- Supports up to 300 lbs

Description	Product No.
Walker	MDS86410W54
Replacement Parts	
Extension Leg	MDS86615E
Glide Caps	MDS86615C
5” Wheel (2/pack)	G07722G



Guardian Adult Walker

- Easy Care Walkers; dual folding mechanism is easy to operate with palms or fingers
- Lightweight aluminum frame with steel cross brace for durability
- Ideal for those with limited dexterity
- Folds to only 4" for easy transport and storage
- 300 lb weight limit
- 5" wheels
- Latex free

Description	Max User Height	Product No.
Adult	6'4"	G30757W
Youth	5'3"	G30758W



Extra Wide Two Button Walker

- Features easy-to-use push-button mechanisms that may be operating by the fingers, palm or side of hand
- Polished aluminum frame
- Folds for easy storage and transportation
- Dual 5" wheels
- 500 lb weight limit
- Height adjust from 33¹/₂" to 43¹/₂" in one-inch increments
- Dimensions: Width inside handgrips: 20¹/₂"; width inside base legs: 28"; depth opened at base: 19"

Description	User Height	Product No.
Adult	5'5" to 6'4"	MDS86410XWW
Replacement Parts		
Extension Leg		MDS86615E
Glide Caps		MDS86615C
8 Hole Footpiece set, 5" Wheel		G07722-8B



Patient Aids

Sidestepper Cane/Hemi-Walker

- Lightweight frame is easy to lift and maneuver
- Dual grip offers extra assistance
- Provides support and stability to those with limited or no dexterity in one arm or hand
- Wide base provides more stability than a quad cane
- 250 lb weight limit

Description	Product No.
Adult	G07770
Youth	G07771



Adult Hemi Walker (not pictured)

- Lightweight aluminum frame with deluxe rubber tips for excellent traction
- Adjustable from 30" to 35"
- Folds to 3" for convenient storage
- Depth (opened at base): 14"
- 250 lb weight limit

Product No. **MDS86620**

Adult Bariatric Folding Walker (not pictured)

- Reinforced aluminum frame with dual steel cross brace
- Extra wide frames with up to 22" between handgrips to accommodate larger users
- 650 lb weight limit

Description	User Height	Product No.
Walker	5'5"-6'4"	G30754B
Replacement Parts		
8-Hole Footpiece Set, 5" Wheel		G07722-8B
5" Wheel		G07722-8

Walker Attachment Platform

- Comfort padded gray forearm cuff
- Universally adjustable latex free hand grip & forearm cuff pads
- Attachment requires two cross braces on the bottom in order to work; it will not work on 1-button or youth walker
- 300 lb weight limit

Product No. **MDS86615P**

Knee Walker (not pictured)

- Weil Knee Walker provides a comfortable alternative to crutches
- Ideal for below-the-knee injuries
- Three-wheel design turns for easy use at home or outside
- Thicker padded seat for comfort
- Equipped with locking hand brakes and a large basket
- Adjustable bench accommodates heights of 4'10"-6'4"
- 300 lb weight limit
- Available in Burgundy

Product No. **MDS86000**



Platform Attachment for Walker (not pictured)

- Acts as a high armrest with hand grip
- Attaches to cross braces (1" diameter) on side of walker
- Useful for taller patients or those who cannot straighten arm to grip the top of the walker
- Weight: 4.71 lbs
- Dimensions: 40¹/₂" (length) x 6¹/₂" (width) x 10¹/₂" (height)
- 300 lb weight limit

Product No. **G07702**

Adult Crutch Attachment Platform

- Platform attaches to the top of the crutch
- Acts as a padded armrest with handgrip
- Useful for those who cannot straighten arm to grip the hand-hold of the crutch

Product No. **G07706**



Leg Extension for Walker

- Includes one pair of glide caps
- Extension legs 14¹/₂" with 5 holes
- Used on MDS86410 series

Product No. **MDS86615E**



Glide Caps

- Includes one pair of glide caps
- Used on MDS86410W54 and MDS86410XWW Two Button Walkers

Product No. **MDS86615C**



Footpiece Extension Set

- Front wheel foot pieces allow you to easily maneuver over surfaces which provide difficulty for walker users
- It also provides a more natural walking stride
- Available in a choice of 3" and 5" inline wheels on 360 degree casters which allow you to change directions with ease

Description	Product No.
3"	G07731G
5"	G07722G
Swivel Set	G07820-8



Patient Aids

Medline - Extra Wide Commode

- This bariatric commode has a back rail that removes quickly and easily for convenient storage and use
- Features a durable, plastic seat with lid plus armrests for additional comfort
- Includes a 10-quart capacity commode bucket with seat cover and splash shield
- Height adjusts from 19.5" to 23.5" in one inch increments
- Non-skid, non-marring rubber tips provide extra safety
- 28" base width, 20.5 overall base depth; 24" width between arms; 14" seat width; 15" overall seat depth; 20.5" seat height
- 650 lb weight limit

Product No.

MDS89664XW



3-in-1 Steel Commode (not pictured)

- Adjustable legs will allow seat to be raised or lowered in 1" increments
- 350 lb weight limit

Product No.

MDS89664H

Universal Fit Commode Bucket

- Constructed of high-impact, white polyurethane
- Universal; fits all Medline commodes
- Complete with handle and lid
- Diameter of bucket is 11"; 12 quart/2 gallon capacity

Product No.

MDS80306B



Patterson Medical - Flexible Inspection Mirror

- Acrylic mirror stays in position when bent
- Adjustable plastic cuff accommodates full palmar grip or finger grasp
- Latex free
- Mirror measures 6" x 4"
- Length: 22"

Product No.

6220

