

Foam Covers

- Endolite BK Foam Cover178
- Endolite Full Shin Knee Frames178
- Endolite AK Foam Cover178
- Fillauer Foam Fairing for Transtibial.178
- Fillauer Transtibial Foam Cover179
- Fillauer B.O.A. BK Cosmesis179
- Fillauer Transfemoral Foam Cover179
- Fillauer Durathane Ankle Block179
- Otto Bock Foam Covers..... 180-181
- SPS Polyethylene Foam Cover182
- Trulife Foam Foot Connector182
- Trulife Foam Covers 182-183
- WillowWood BK Foam Cover.....183
- WillowWood Pathfinder II BK Cover183
- WillowWood AK Foam Cover.....184

Prosthetic Skins

- ALPS EasySkin.184
- Fillauer Pe-Lite Leg Cover184
- Fillauer Dream Skin185
- PRS U-Flate Sleeves186
- PRS One Step Ahead Skin Sleeve187
- Steeper USA Skinergy Plus188
- ST&G EZ Cover188

Cosmetic Stockings

- Comfort Products189
- Knit-Rite. 189-190
- Otto Bock191

Endolite - BK Foam Cover

- Shin fairing
- Plastazote closed cell cover

Size	A*	B*	C*	D*	Product No.
Small	470	135	85	27	561014
Medium	470	155	85	27	561015
Large	470	175	85	27	561012

* all dimensions in mm

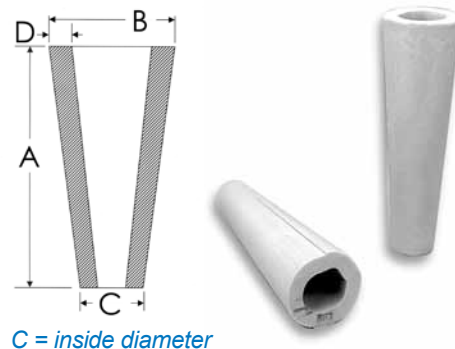

Full Shin Knee Frames

For Endolite AK Systems	Product No.	
	Right	Left
Small (preformed)	561017	561016
Large (preformed)	561019	561018
Universal Partially Shaped	561020	



AK Foam Covers

- For 30 mm pyramid based DuraFoam systems
- Internal 55 mm bore

Description	Product No.
Bore extends 200 mm below knee center (SM)	560031
Bore extends 50 mm below knee center (LG)	560032

Fillauer - Foam Fairing for Transtibial

- Closed cell polyethylene foam
- Medium density

Size	Product No.
6" Diameter x 18"	189112
6" Diameter x 18" with cavity	189118
6" Diameter x 21.5"	189116
6" Diameter x 24"	189117



Trans tibial Foam Cover

- 21 1/2" - BK

Product No. **189122**



189122

B.O.A. BK Cosmesis

- Preshaped cone for B/K cosmesis made of flesh colored CenPol
- CenPol is a high quality closed cell material which prevents it from absorbing moisture and is easy to grind

Product No. **721000100**



721000100

Trans femoral Foam Cover

- 30"

Product No. **189120**



189120

Durathane Ankle Block

- Lighter and easier to shape than wood
- Foot bolt retainer can be used with SACH or Single Axis foot

Length	Bolt	Product No.
5 3/4"	Standard SACH 3/8" bolt	55915
5 3/4"	Threaded 10 mm bolt	70477
8"	Standard SACH 3/8" bolt	55917
8"	Threaded 10 mm bolt	70479
12"	Standard SACH 3/8" bolt	70048
12"	Threaded 10 mm bolt	70481



55915



70048

Otto Bock - 3R6 Foam Cover

- For Knee Joints: 3R15, 3R49, 3R55, 3R21, 3R23, 3R30, 3R32, and 3R46
- Appropriate for modular transfemoral prostheses
- Drilled with stepped center hole
- Pre-shaped
- Length = ~94 cm
- Knee Flexion: 30°
- Material: PUR flexible foam
- Color: Beige

Description	Calf Circ.	Product No.	
		Left	Right
Leg Foam Cover	36 cm	3R6=L36B	3R6=R36B
Leg Foam Cover	44 cm	3R6=L44B	3R6=R44B



3S26 Cosmetic Foam Cover (AK)

- For Knee Joints: C-Leg® (3C88-1 and 3C98-1) Compact (3C86 and 3C96)
- Appropriate for modular transfemoral prostheses
- Drilled with stepped center hole
- Pre-shaped
- Length = ~94 cm
- Calf Circumference: 44 cm
- Knee Flexion: 30°
- Material: PUR flexible foam
- Color: Beige

Description	Product No.
Left Leg	3S26=L44
Right Leg	3S26=R44



6R18 Cosmetic Foam Cover (PE) pre-shaped

- Appropriate for modular transtibial prostheses
- Drilled with 30 mm or 34 mm hole diameters
- Pre-shaped
- Length = ~48 cm
- Universal (left or right)
- Material: PE foam
- Color: Beige

Tube Diameter	Product No.
30 mm	6R18=30
34 mm	6R18=34



6R6 Foam Cover

- For Knee Joints: 3R21, 3R23, 3R30, 3R32, 3R46, 3R60=KD, 3R60-PRO=KD, and 3R106=KD
- Appropriate for modular transtibial and knee disarticulation prostheses
- Drilled with center hole compatible for either 30 mm or 34 mm diameter systems
- Universal (left or right)
- Length = ~55 cm
- Material: PUR flexible foam
- Color: Beige

Product No. **6R6=B**



6R8 Foam Cover

- Appropriate for modular transtibial prostheses
- Drilled with center hole for 30 mm or 34 mm hole diameters
- Pre-shaped
- Length = ~48 cm
- Universal (left or right)
- Material: PE foam
- Color: Beige

Tube Diameter	Product No.
30 mm	6R8=30
34 mm	6R8=34



3R24 Foam Cover

- For Knee Joints: 3R17, 3R20, 3R22, 3R33, 3R34, 3R36, 3R40, 3R95 and 3R95=1
- Appropriate for modular transfemoral prostheses
- Drilled with stepped center hole
- Pre-shaped
- Length = ~94 cm
- Knee Flexion: 30°
- Material: PUR flexible foam
- Color: Beige

Description	Calf Circ.	Product No.	
		Left	Right
Leg Foam Cover	36 cm	3R24=L36	3R24=R36
Leg Foam Cover	40 cm	3R24=L40	3R24=R40
Leg Foam Cover	44 cm	3R24=L44	3R24=R44

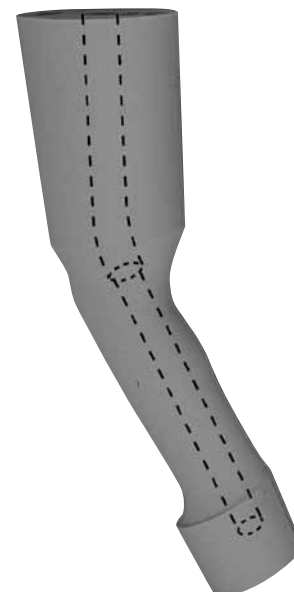

SPS - Polyethylene BK Wrap Foam Cover

- Easily Shaped
- Measures 18" x 20" x 2"

Product No. **SPS700**



Trulife - Foam Foot Connector

- For use with soft foam covers
- Firm expanded polyethylene 1" thick
- Provides a non-rigid transition between the foot and foam cover

Product No. **P21406**

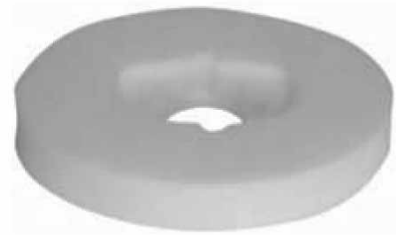

Endoskeletal Cosmesis

- Appropriate for transtibial amputees using any model of the Turas, Carbon LightFoot, Seattle LightFoot, Natural Foot, SACH foot, LightFoot2, or Carbon LightFoot 2
- Replace ?? with foot size
- Replace ? with Side

Size	Color	Height	Product No.
Short Cosmesis Sizes 22-26 cm	Caucasian	10.3"	SEC201-???
	Light Brown	10.3"	SEC206-???
	Dark Brown	10.3"	SEC210-???
Tall Cosmesis Sizes 26-29 cm	Caucasian	15.5"	SEC202-???
	Light Brown	15.5"	SEC207-???
	Dark Brown	15.5"	SEC211-???



Round BK Foam Cover

- 6" x 21"

Product No. **218050000**



Soft Foam Covers

- Preshaped 36" length

Size	Product No.	
	Right	Left
18" Core	P41821	P41820
24" Core	P41823	P41822

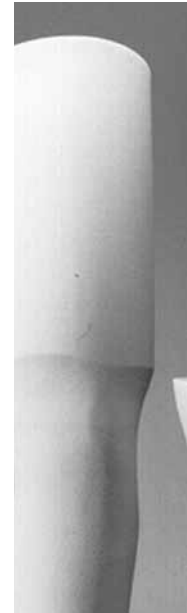

WillowWood - BK Foam Covers

Size	Color	Product No.
1" (25 mm)	Buff	700-BKX-025C
1" (25 mm)	Medium Brown	700-BKX-025N
1 1/4" (32 mm)	Buff	700-BKX-032C
1 1/4" (32 mm)	Medium Brown	700-BKX-032N



Cosmetic
Coverings

Pathfinder II BK Covers

- Lower part has figure-8 configuration to fit over Pathfinder foot
- Top foam has a single center hole

Color	Product No.
Buff	700-BKX-PFRB
Medium Brown	700-BKX-PFRM



WillowWood - AK Foam Covers

Side	Center Hole	Buff	Med. Brown
Left	Extended	700-1AKL-EC	700-1AKL-EN
Right	Extended	700-1AKR-EC	700-1AKR-EN
Left	Regular	700-1AKL-RC	700-1AKL-RN
Right	Regular	700-1AKR-RC	700-1AKR-RN

Easy Shape			
Left	Extended	700-3AKL-EC	700-3AKL-EN
Right	Extended	700-3AKR-EC	700-3AKR-EN
Left	Regular	700-3AKL-RC	700-3AKL-RN
Right	Regular	700-3AKR-RC	700-3AKR-RN

Pathfinder II AK Covers			
Left	Regular	700-1AKL-PFRB	700-1AKL-PFRM
Right	Regular	700-1AKR-PFRB	700-1AKR-PFRM



ALPS - EasySkin

- Pre-stretched, heat shrink to fit
- Minimal compression of the foam
- No transition line at the ankle
- Highly conformable
- Six month warranty
- Shades available: 3, 5, 7, 9, 11, 12 and 13
- Replace ? with color code

Size	Foot Length	Ankle	Calf	Product No.
Small	18-23 cm	17-22 cm	25-35 cm	TSK ?-S
Large	23-30 cm	22-29 cm	35-45 cm	TSK ?-L



Fillauer - Expanded Pe-Lite™ Leg Cover

- Suede like finish
- Easily cleaned and durable
- Shrinks to shape when heated
- For transtibial prosthesis

Size	Base	Brim	Length	Product No.	
				Beige	Caucasian
Small	7-9 ¹ / ₂ "	9-14 ¹ / ₂ "	20"	127788	127794
Medium	7 ¹ / ₂ -11"	11-18"	21"	127790	127796
Large	9 ¹ / ₂ -12"	13-21"	22"	127792	127798

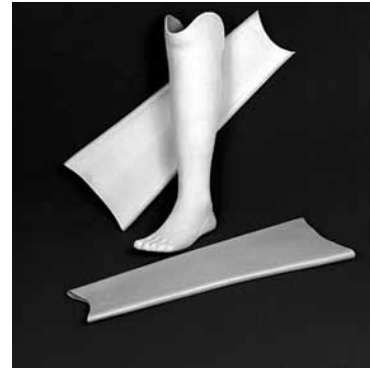

Dream Skin

- Micro-coating resists marks, cleans easily, and reduces friction
- 5 sizes, based on foot sizes 21 to 30 cm
- 18 colors for color matching
- Cosmetic, more natural appearance
- Water resistant material
- Expanded ankle for easy fabrication and a custom fit
- Heat shrinkable
- Replace xx with swatch color code



04	05	06
07	08	09
10	11	12
13	14	15
16	17	18

611200002

Cosmetic
Coverings

Dream Skin Swatch

Product No. **611200002**

Solid Toe					
Foot Size	Calf Size	Ankle Size	Length	Product No.	
				Left	Right
21-22 cm	30.5 cm	19 cm	19.68 in	421221xx4	421222xx4
23-24 cm	32 cm	20 cm	21.65 in	423241xx4	423242xx4
25-26 cm	34 cm	21 cm	23.62 in	425261xx4	425262xx4
27-28 cm	35.5 cm	21.5 cm	21.65 in	427281xx4	427282xx4
29-30 cm	37 cm	22 cm	23.62 in	429301xx4	429302xx4
Split Toe					
21-22 cm	30.5 cm	19 cm	20.27 in	421223xx4	421224xx4
23-24 cm	32 cm	20 cm	21.65 in	423243xx4	423244xx4
25-26 cm	34 cm	21 cm	23.62 in	425263xx4	425264xx4
27-28 cm	35.5 cm	21.5 cm	24.41 in	427283xx4	427284xx4
29-30 cm	37 cm	22 cm	26.77 in	429303xx4	429304xx4

Prosthetic Research Specialists - U-Flate Skin Sleeves

- Easy to use, removable, inflatable and heat shrinkable
- Skin tones available in 33 shades
- Comes in 4 sizes that will fit all patients
- Can also be waterproofed so the amputee will be able to shower with the skin
- (Please refer to the Prosthetic Research Color Swatches, Otto Bock use 1-18, REALASTIC use R05, R09, R13, R17, R21, R25, R29, R33, R37, R41, R45, R49, R53, R57 and R61)*



Description	Product No.
BK - 24" Long	BKUF??
AK - 32"-36" Long	UF??

Ordering Example
 Style **BKUF**
 Size **M**
 Color* **R25**
BKUFMR25

Size	Length	Ankle		Calf		Thigh		Min. Foot Size
		Min.	Max.	Min.	Max.	Min.	Max.	
X-Small	30"	6 ¹ / ₈ "	12"	8 ³ / ₄ "	16"	12"	20"	18 cm
Small	36"	6 ³ / ₄ "	12"	12 ¹ / ₄ "	20"	14"	22"	22 cm
Medium	36"	9"	16 ¹ / ₂ "	15"	25"	17 ¹ / ₂ "	27"	25 cm
Large	36"	11"	—	17"	—	19 ¹ / ₂ "	—	27 cm

U-Flate Expansion Platform

- A round piece of plastic with a valve stem like a car tire and a big hose clamp that fits around the outside
- It is used to inflate the skin and stretch it, so it will be easier to get over the prosthesis
- After it is over the prosthesis, heat the skin and it shrinks back to size



Product No. **UF100**

One Step Ahead Skin Sleeve

- Removable skin sleeve
- When properly used, the amputee can shower or swim wearing the “One Step Ahead” skin
- Color: Please refer to the Prosthetic Research Color Swatches Otto Bock, use 1-18; REALASTIC, use R05, R09, R13, R17, R21, R25, R29, R33, R37, R41, R45, R49, R53, R57 and R61
- Replace first ? with size and second ? with color



Description	Product No.
Above Knee	1SAK-?-?
Below Knee	1SBK-?-?

AK or BK Size	Ankle	Calf	Thigh	BK Length	AK Length	Foot Size
0	6 ³ / ₄ "	11 ³ / ₄ "	17"	19"	25 ¹ / ₂ "	23-28 cm
1	7 ³ / ₄ "	13"	19"	19"	30"	23-28 cm
2	8 ¹ / ₂ "	14 ¹ / ₄ "	20"	19"	31"	23-28 cm
3	9 ¹ / ₂ "	15 ¹ / ₂ "	22"	21"	31"	23-28 cm
4	9 ¹ / ₂ "	16 ¹ / ₄ "	24"	21 ¹ / ₂ "	31"	23-28 cm
5	8 ¹ / ₂ "	16"	22"	18 ¹ / ₂ "	30"	23-28 cm
6	7 ³ / ₄ "	13 ¹ / ₄ "	16"	18"	31"	23-28 cm
7	7 ³ / ₄ "	13 ³ / ₄ "	26 ¹ / ₂ "	18"	31"	23-28 cm
8*	9 ¹ / ₄ "	15 ¹ / ₄ "	29 ¹ / ₂ "	20"	27"	23 cm max
9*	9 ¹ / ₂ "	16 ¹ / ₂ "	26 ¹ / ₂ "	20"	27"	23 cm max
10	8 ¹ / ₂ "	11"	16 ¹ / ₂ "	19"	31-27"	23-28 cm
11	9 ¹ / ₂ "	14"	20 ¹ / ₂ "	20"	31"	23-28 cm
12	8 ³ / ₄ "	15 ¹ / ₄ "	25 ¹ / ₂ "	20"	31"	23-28 cm
13	9"	12"	15"	20"	31"	23-28 cm
14	7 ¹ / ₂ "	11 ¹ / ₄ "	18"	20"	31-39"	23-28 cm
15	8 ¹ / ₂ "	13 ¹ / ₄ "	20 ¹ / ₂ "	20"	31"	23-28 cm
16	10 ¹ / ₂ "	14"	18"	20"	31"	23-28 cm
17	8 ¹ / ₂ "	15"	15 ¹ / ₂ "	20"	31"	23-28 cm
18	9 ¹ / ₄ "	15"	24 ³ / ₄ "	20"	31"	23-28 cm
19	8 ¹ / ₄ "	13 ¹ / ₄ "	19"	20"	31"	23-28 cm
20	9 ³ / ₄ "	14 ³ / ₄ "	24"	20"	31"	23-28 cm
21	11"	16"	20"	20"	31"	23-28 cm
22	8 ¹ / ₄ "	13 ¹ / ₄ "	13 ¹ / ₄ "	20"	31"	23-28 cm
24	9 ³ / ₄ "	15 ¹ / ₄ "	19 ³ / ₄ "	20"	31"	23-28 cm
27	9 ¹ / ₂ "	15 ⁷ / ₄ "	18 ¹ / ₄ "	20"	31"	23-28 cm
CH1**	5 ³ / ₄ "	8"	10 ¹ / ₂ -14 ¹ / ₂ "	N/A	26"	15-17 cm
CH2**	6"	9"	11-14 ¹ / ₂ "	N/A	26"	17-29 cm
CH3**	7"	10"	12-15"	N/A	26"	18-20 cm
Infant	6"	8"	8"	N/A	18"	11-13 cm

*Sizes 8 and 9 will fit a 23 cm max foot size **Child sizes available in AK only

Steeper USA - Skinergy™ Plus

- Integrated reinforcing mesh and advanced silicone material for a more durable finish
- Seamless design; easy to clean
- Adult foot sizes 22 cm to 30 cm
- Available in Split Toe or Closed Toe
- 19 color shades with unique True Finish™ - 0-18 (color swatch available upon request)
- Replace ? with color



Foot Size	Mid Calf Circ.		Top of Cover Circ.		Cover Length from Floor to:		Split Toe		Closed Toe	
	Min.	Max.	Min.	Max.	Mid-Calf	CoverTop	Left	Right	Left	Right
22/23	28	35	26	32.5	32	55	TLC22LS/E?	TLC22RS/E?	TNS22LS/E?	TLC22RS/E?
	32	40	30	37.5			TLC22LL/E?	TLC22RL/E?	TNS22LL/E?	TNS22RL/E?
24/25	31	39	29	36	34.5	57	TLC24LS/E?	TLC24RS/E?	TNS24LS/E?	TNS24RS/E?
	35	44	33	41			TLC24LL/E?	TLC24RL/E?	TNS24LL/E?	TNS24RL/E?
26/27	32	40	30	37.5	37	61	TLC26LS/E?	TLC26RS/E?	TNS26LS/E?	TNS26RS/E?
	37	46	35	44			TLC26LL/E?	TLC26RL/E?	TNS26LL/E?	TNS26RL/E?
28/30	34	42.5	32	40	39.5	66	TLC28LS/E?	TLC28RS/E?	TNS28LS/E?	TNS28RS/E?
	39	49	37	46			TLC28LL/E?	TLC28RL/E?	TNS28LL/E?	TNS28RL/E?

All measurements are in centimeters

Cosmetic Coverings

ST&G - EZ Cover

- Made of proprietary thermoplastic mesh
- Coated to provide the right balance between rigidity and flexibility
- Special tape bonds the mesh material to a smooth surface
- Hygienic and easy to revise when needed
- Preformed shape makes it easy to adjust by hand without heat

Product No. **4001EZ**



Comfort Products - Cosmetic Stockings

- Uniformly controlled compression
- Heavy weight 100% nylon
- Available colors: Caucasian, Hispanic, Light Negroid, Dark Negroid
- Sold in pairs
- Knitted heel
- Plain stretch top for BK and elastic top for AK

Size	Length	Product No.			
		Caucasian	Hispanic	Lt. Negroid	Dk. Negroid
BK-1	22"	98BHT161C	98BHT161H	98BHT161L	98BHT161D
BK-2	25"	98BHT162C	98BHT162H	98BHT162L	98BHT162D
BK-3	28"	98BHT163C	98BHT163H	98BHT163L	98BHT163D
AK-0	36"	98AHT140C	98AHT140H	98AHT140L	98AHT140D
AK-1	38"	98AHT141C	98AHT141H	98AHT141L	98AHT141D
AK-2	40"	98AHT142C	98AHT142H	98AHT142L	98AHT142D
AK-3	42"	98AHT143C	98AHT143H	98AHT143L	98AHT143D
AK-4	44"	98AHT144C	98AHT144H	98AHT144L	98AHT144D

Knit-Rite - Cosmetic Underhose

- 100% stretch nylon
- Available in above and below knee lengths
- Sold in pairs

Above Knee Cosmetic Underhose			
Size	Foot Size	Product No.	
		Brown	Dusk
Small	8 ¹ / ₂ -9 ¹ / ₂ " (21.5-24 cm)	2H7391SM	2H7390SM
Medium	9 ¹ / ₂ -10 ¹ / ₂ " (24-26.5 cm)	2H7391MD	2H7390MD
Large	10 ¹ / ₂ -11 ¹ / ₂ " (26.5-29 cm)	2H7391LG	2H7390LG
X-Large	11 ¹ / ₂ -12 ¹ / ₂ " (29-32 cm)	2H7391XL	2H7390XL
X-Large X-Long	11 ¹ / ₂ -12 ¹ / ₂ " (29-32 cm)	2H7391LL	2H7390LL
Knee Length Cosmetic Hose			
Small	8 ¹ / ₂ -10" (21.5-25 cm)	2H7396SM	2H7395SM
Large	10 ¹ / ₂ "-12" (26.5-30.5 cm)	2H7396LG	2H7395LG
King	12"-13" (30.5-33 cm)	2H7396KG	2H7395KG

Cosmetic Stockings for Modular Prostheses

- Elasticized silicone cuff
- 100% nylon (except elastic)
- Available in above and below knee lengths
- Sold in pairs
- When replacing, refer to color-coded thread inside proximal stocking

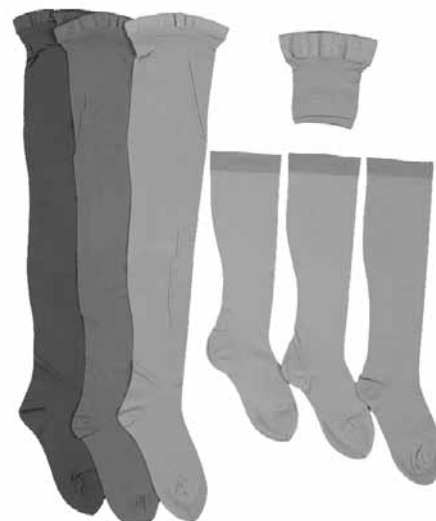

Size Chart for Modular Above Knee Prostheses

Size	Color Reference	Top Circ.	Leg Length	Foot Length	Product No.		
					Caucasian	Negroid	Hispanic
0	Natural	36 cm	72 cm	20 cm	2HB9B140	2HR9B140	2HL9B140
I	Green	36 cm	76 cm	20 cm	2HB9B141	2HR9B141	2HL9B141
II	Black	36 cm	78 cm	20.5 cm	2HB9B142	2HR9B142	2HL9B142
III	Pink	40 cm	80 cm	21 cm	2HB9B143	2HR9B143	2HL9B143
IV	Blue	40 cm	90 cm	22 cm	2HB9B144	2HR9B144	2HL9B144
Size Chart for Modular Below Knee Prostheses							
0	Green	25 cm	36 cm	20 cm	2HB9B161	2HR9B161	2HL9B161
I	Black	25 cm	41 cm	21 cm	2HB9B162	2HR9B162	2HL9B162
II	Pink	27 cm	46 cm	22 cm	2HB9B163	2HR9B163	2HL9B163

Proximal Connection Piece

- Used for holding the foam cover to the above knee socket
- Sold each
- Caucasian

Size	Top Circ.	Product No.
I (Green)	28 cm	2HB9B151
II (Black)	34 cm	2HB9B152
III (Pink)	40 cm	2HB9B153

Otto Bock - 99B116 Soft Touch Protective Outer Surface Cover

- Special surface coating adds water and dirt resistance
- Extremely stretchable
- Fit transtibial prostheses
- Replace ?? with color when ordering

Size	Calf Circ.	Ankle Length	Foot Length	Product No.
Small (2)	30-33 cm	19-21 cm	≥ 21 cm	99B116=2-??
Medium (4)	34-39 cm	22-25 cm	≥ 23 cm	99B116=4-??
Large (6)	40-45 cm	26-29 cm	≥ 25 cm	99B116=6-??
Colors: 0, 2, 4, 6, 8, 10, 12, 14, 16 or 18				

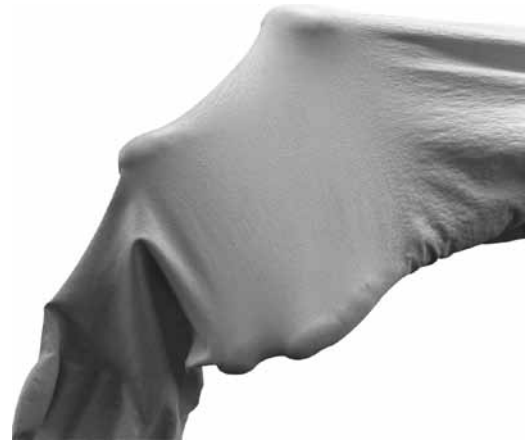

Ordering Example

Style **99B116**
 Size **2**
 Color* **6**

99B116=2-6

99B16 Perlon Knee Stockings

- Intended for outer cosmetic finish of modular transtibial prostheses
- Banded collar radius is ~11.5 cm for all sizes

Size	Length	Ankle Radius	Foot Length	Product No.	
				Tan	Brazil
1	~38.5 cm	~9 cm	~17.5 cm	99B16=1	99B16=1B
2	~40.5 cm	~9.2 cm	~18.5 cm	99B16=2	99B16=2B
3	~44.5 cm	~9.25 cm	~19 cm	99B16=3	99B16=3B



99B14 Perlon Cosmetic Stockings

- Intended for outer cosmetic finish of modular transtibial prostheses

Size	Length	Ankle Radius	Foot Length	Collar Radius	Product No.	
					Tan	Brazil
0	~59 cm	~9 cm	~18 cm	~15 cm	99B14=0	99B14=0B
1	~61.5 cm	~9 cm	~19 cm	~16 cm	99B14=1	99B14=1B
2	~66 cm	~9 cm	~20 cm	~17 cm	99B14=2	99B14=2B
3	~72 cm	~9.25 cm	~20.5 cm	~18 cm	99B14=3	99B14=3B
4	~83.5 cm	~9.5 cm	~21 cm	~19 cm	99B14=4	99B14=4B

